



# ELEVATING LIFE

Automated Car Parking Solutions



## ABOUT

WE ARE INDUSTRY EXPERTS WITH MORE THAN 25 YEARS OF EXPERIENCE

**Descon Infrastructures Pvt. Ltd.** is an engineering organisation shaping the face of highway & urban infrastructure ecosystem. The conventional design modules of the last century are being constantly replaced with designs & technologies which are functional, smart and sustainable over longer period of time.

As an infrastructure development firm, **Descon** designs and constructs products as well as services showcasing modern and innovative technology to deliver a smart and sustainable future. In the 25th year of it's operation, **Descon** is proud to present itself as an engineering organisation catering to the various infrastructural demands to help build a better and safer today.

In order to enrich the quality of the infrastructure and tackle a number of modern issues being faced by urban planners, **Descon** together with Sotefin S.A is proud to present automated car parking solutions. With the help of such smart & integrated parking solutions, infrastructure ecosystem of existing urban establishments can be upgraded so as to allow for a more efficient use of the available space and provide seamless connectivity.

## VISION

Design + Construction; To enrich the quality of the infrastructure ecosystem with smart, safe and integrated solutions.

## MISSION

- 1) To introduce innovative solutions to help accelerate sustainable development & growth.
- 2) To build & grow on a foundation of sustainable ethical practices.
- 3) To share latest developments, emerging trends & technological advances with communities

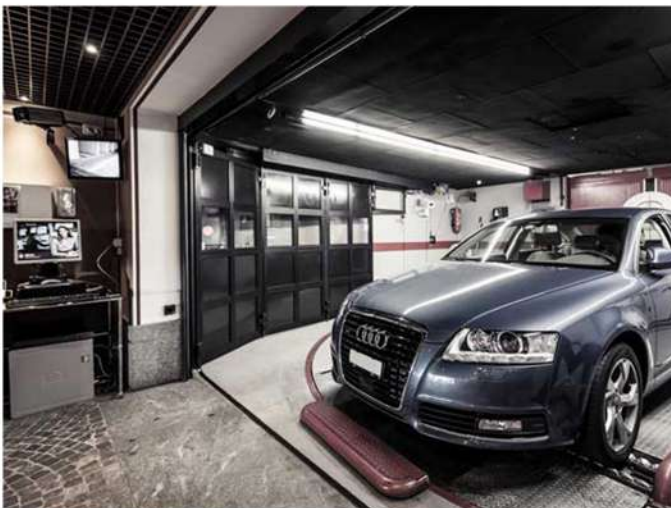



# About Sotefin

A Six decade legacy decoded for a young India marks the presence of **Sotefin** India is a nation of change. It is one of the fastest growth growing technical geographies with a natural affinity towards technology. The technology adoption by the youth in India is amongst the highest in the world. So what do you do to a country that is getting , innovating, and becoming one of the technical power houses of the world?

We simplify their lives through a series of complex **Made to Measure** robotic systems that will help India focus on what it does the best ... "Make a lasting impact on the world"

**Sotefin** offers customized end to end mechanical parking solutions that down-scales India's constraint issue to unimaginable limits. Our offering is unique amongst competition, we offer solutions from planning, design, construction, implementation to operations and maintenance as part of a turn-key project. What further sets us apart is that we are enabled with technology that thinks. Yes, it thinks to achieve precise and calculated results.

Our parking systems are accurate to the inch.. So whether your car mirrors are open or folded... it really doesn't matter. We have a new calculation every time your car enters our parking system.

## **Design & Drawing to the Parking system**

Our engineers are skilled at capitalizing on the opportunities that the latest ways of working present. Because we have the right people and tools in place, we will design the best possible parking solution for you.

## **Design & Drawing**

At **Sotefin**, we are not just about the right people, but also the right technical tools. We do more than just design car parking system for you. We also provide structural design services so that have the right structure for housing your new automated parking garage.

## **Annual Maintenance**

We recommend getting your parking system undergo a comprehensive service at least twice a year to maintain the reliability of the system. We offer different choices for maintenance to ensure that down time is minimized along with the costs.

## **Operation**

We have ensured that our systems are incredibly simple to use. But for clients that prefer the touch of a human element, we provide additional support staff that has been trained for taking care of the maintenance services as well.



## Ushering in a new era of intelligent Car Parking Systems

A profound legacy of innovation and leadership of over 6 decades is what best defines **Sotefin**. The company was founded in 1956 by a group of technocratic evangelists and has since become global leader in the field of automated and robotic car parking systems.

The spark that set a technical revolution, was an intelligent trolley design the **Silomat Dolly** which was awarded a patent in 1959. This simple component of a larger system that allowed vehicles to be transferred automatically, would go on to re-define the automated parking landscape. This announced the foray of **Sotefin SA** in the precision and intelligent technology for car parking, which to date is proven best amongst the incredibly accurate and reliable parking systems of the world.

**“ Focus and simplicity ”**  
Simple can be harder than complex;  
you have to work hard to make it simple.

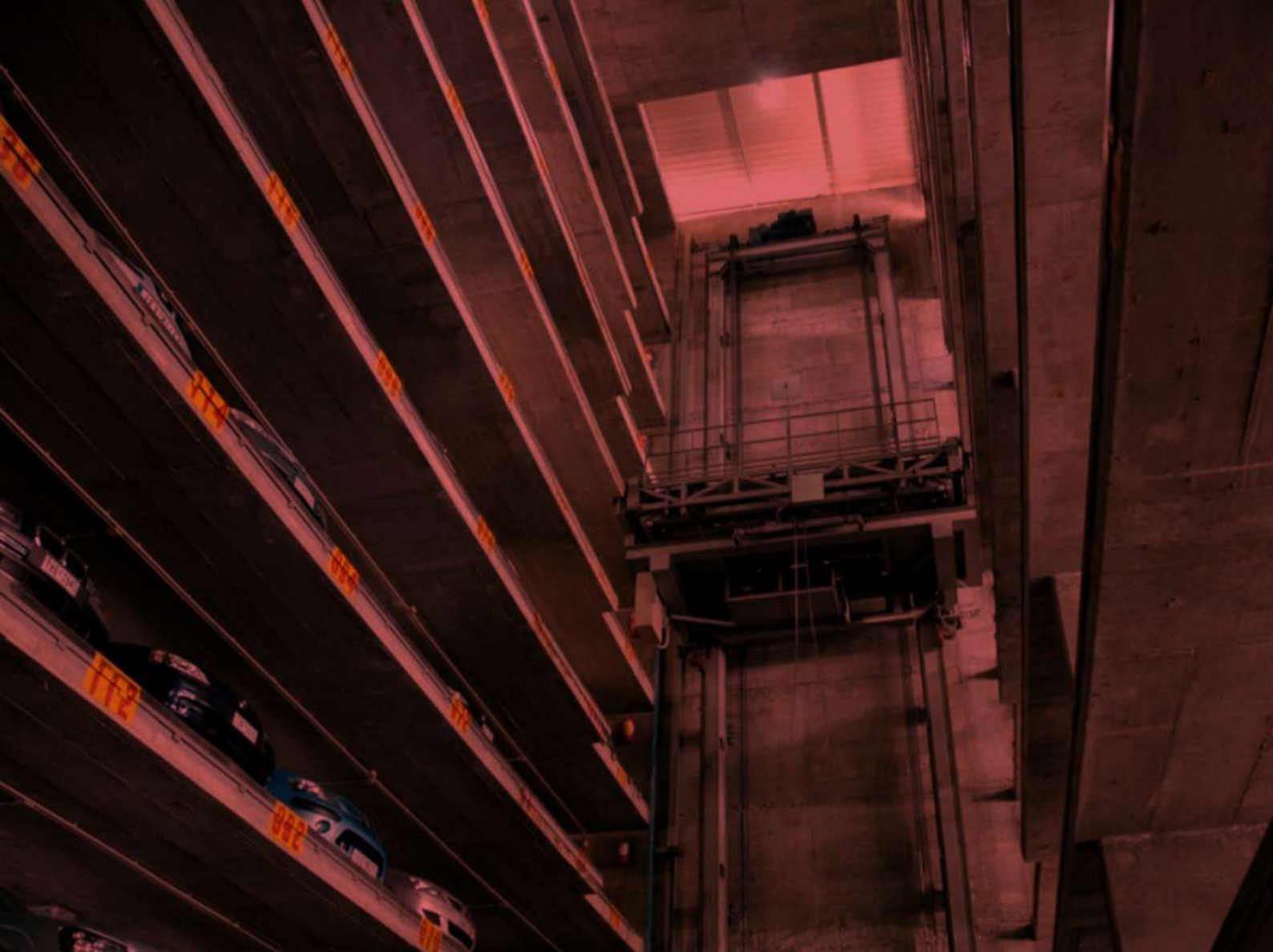

# What drives our success story

- Turnkey project solution
- Maximum realisation of public parking garage where down time must be zero.
- Over 50 years' design know-how and experience.
- High product versatility allowing it to be tailor-made to new buildings or renovations.
- Realisations in over 20 countries.
- Ability to design, build and co-ordinate large installations.
- Flexible allowing "made to measure" car parks.
- 360° assistance.

At Sotefin Parking, we believe in ensuring that you can make the most out of the products we offer. As such, we offer managed solutions which can ensure that you do not run into any roadblocks whatsoever down the line.

Sotefin, in the course of its existence, has designed & installed more than 450 automatic parking units in over 30 countries. Currently the parking spaces realized by Sotefin exceeds by 35,000 units of which more than 3,000 in the last two years.

# SOTEFIN PARKING SYSTEMS



## Product Range

### 1. **Robotic Shuttle Dolly - Patented Silomat**

The Silomat carriage is the synthesis of 50 years of evolution and innovation. It is at the heart of the parking system as it is a device dedicated to the direct movement of automobiles. The Silomat carriage summarises the most technologically advanced product offered today on the automatic car park market. It is the most compact & complete movement carriage in the history of automatic car parks. The main functions of a vehicle movement carriage is centering, lifting and traversing are realised for the first time in one sole device which also boasts the best performance in terms of speed and space-saving compared to all it's competitors.

### 2. **Vertical Transporter**

The Vertical Transporters allow vehicles to be moved vertically to transport them to the various car park levels configured for the car park. Sotefin has developed about ten Vertical Transporters models in order to ensure that our systems are adaptable to any type of building.



### 3. Undercarriages/Shuttle

Undercarriages are devices designed for the vehicle to be transported horizontally so that it is positioned in front of its designated parking space or to the entrance and exit areas. They can be combined with a Vertical Transporter.

### 4. Traversing Towers

Traversing towers combine the Vertical Transporter's and under carriage's functionality in one device. It moves the vehicle vertically and horizontally at the same time.

### 5. Turning Platforms

Turning platforms allow the vehicle to be turned in the directions of the entrance and exit to facilitate incoming and outgoing operations for the users.



## Salient Features:

- Time tested and most reliable parking system technology worldwide
- Boasts the best performance in terms of speed & space saving compared to all its competitors
- Independent access for car retrieval
- Flexible tailor-made design to fit into new buildings or renovations
- Can be above ground or under ground or combination of both
- Ability to design, build large installation with great sizing capacity ( From 8 to thousand to car spaces )
- Adaptable to Individual project requirement corresponding to car height, width, length and weight
- Options to Integrate Turn table
- Suitable for large public pay parking
- High speed elevator system with state of the art technology



# System Range

## 1. Automatic Tower Parking

Fully automated comb type or pallet type tower parking systems could be multiple levels (from 10 to 25 levels) allowing numerous vehicles to be stored in a small floor area (7x7 meter or 8x8 meter). In fact, it can be a stand alone tower or inside the building shaft. Understandably, this is one of the most efficient uses of parking space, providing maximum ECS benefit.

The tower parking systems are best used in residential tower buildings & commercial buildings that have higher parking requirement. For Commercial buildings, stand alone towers unique opportunity of advertisement space.

### Salient Features:

- Very High ECS as the system requires very less ground area
- Fully automated and independent access for car retrieval
- Can be above ground or pit type or combination of both
- Single entry/exit system: minimum to zero requirement of drive way
- Options to integrate turn table
- High speed elevator system with state of the art technology
- Comb type tower is very energy efficient

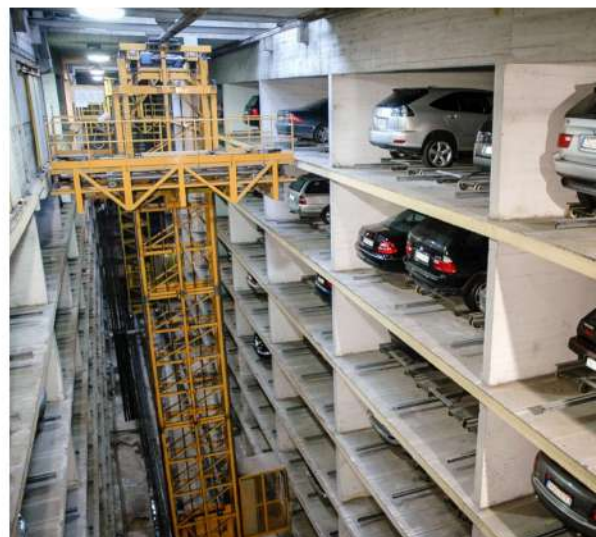





## 2. Automatic Pallette Type Parking

A car parking pallette is a flat, movable structure for a car to sit upon as it is transported and parked within a parking system. The car remains on the pallette until it leaves the parking system. Our entreprise has been working hard to gain immense recognition in manufacturing, exporting and supplying array of quality assured pallette slide parking systems.

We design and manufacture pallette slides by using quality approved components and advance technology under the supervision our diligent professionals. Furthermore, this pallette slide is made available with us in many specifications and customization options at market leading prices.

### Salient Features:

- Independent access for car retrieval can be above ground or under ground or combination of both
- Ability to design build large installation with great sizing capacity (From 8 to thousand of car spaces)
- Adaptable to individual project requirements corresponding to car height, width, length and weight
- Very fast retrieval process
- Options to integrate turn table
- Suitable for large public pay parking
- High speed elevator system with state of the art technology

### 3. Puzzle Parking System

The electro-mechanical puzzle parking system can be said to be a combination of pallet and stack systems. In it, the car is first placed onto a platform before being lifted up to appropriate level. You can maximize the parking space available by keeping multiple cars on top of each other.

It is possible to load and unload a vehicle individually without the need for taking out the other cars underneath. As a result, the system is completely independent. This is due to the multiple entries available for the parking lift system. As such, drivers will have to wait for a very little period to retrieve or park the car in the desired location.

The puzzle parking system is certainly capable of accommodating SUV easily along with all sorts of sedans and hatchbacks with the option of multiple levels and rows.

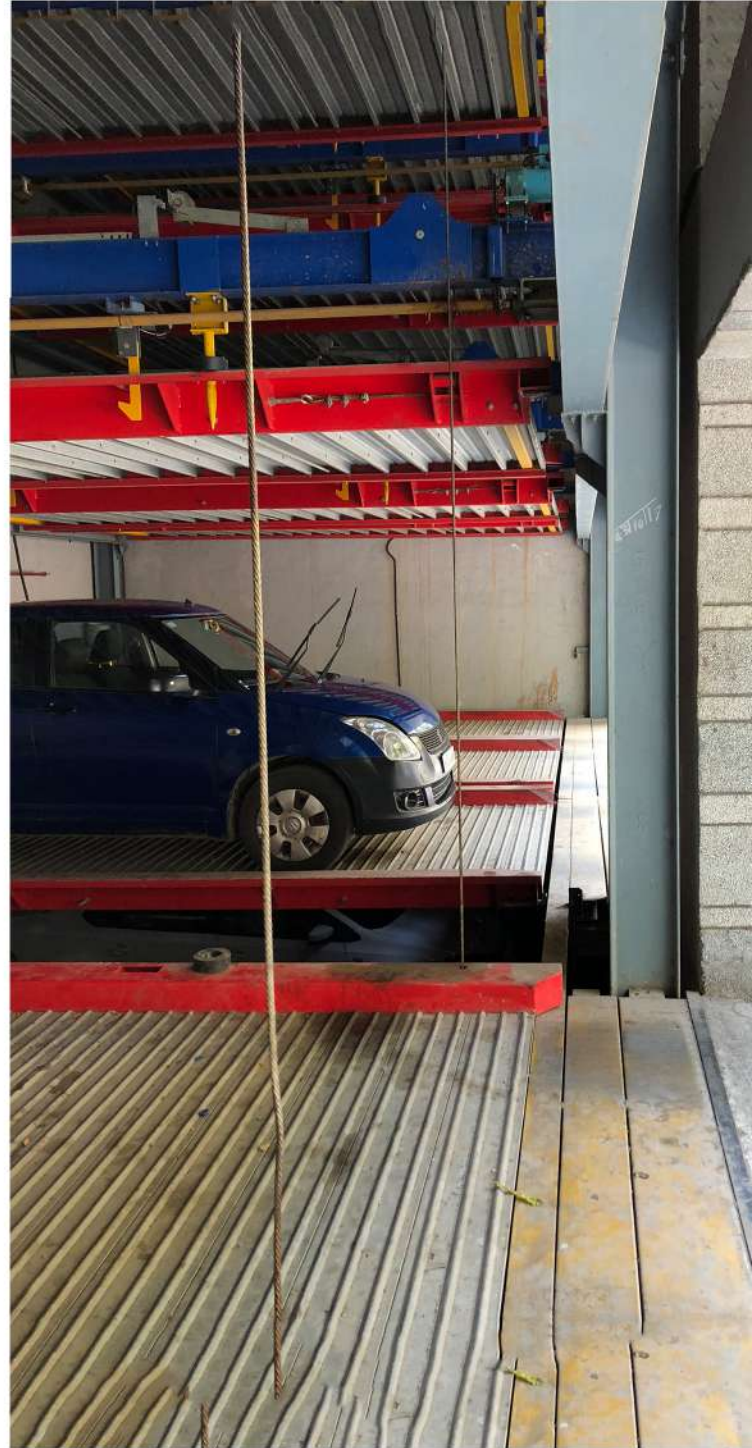

#### Salient Features:

- Most user friendly system
- Multi point entry/exit
- Independent access for car retrieval
- Can be above ground or pit type or combination of both
- Delivers faster retrieval than conventional ramp based parking
- Low construction, operation & maintenance cost
- Suitable for both indoor & outdoor installation
- High level of safety according to EN norms



## 4. Stack Parking

With the stack parking system, the parking space can be optimized with minimum cost. After all, it allows to store multiple cars in a single space. As a result, the parking space available can be multiplied by 2 to 4 times which is certainly going to be beneficial for the establishment.

This parking lift system features multiple platforms which operate in a dependent manner. In other words, the lower platforms must be empty before the cars in the upper platforms can be taken out. However, the operation and maintenance of the lift is quite simple which keeps the cost down.

In fact, the system is quite a cost-effective method for multiplying the available parking space. Another advantage of our system is that there is no need for a pit. This keeps the installation costs down as well. The cars can be accessed within 60 seconds only to get one back from the system.

---

### Salient Features

- Simplest form of mechanized parking
- Very rugged and robust electro-mechanical design
- Dependent access for car retrieval
- Very low construction, operation & maintenance cost
- Suitable for both indoor & outdoor installation
- Easy and low noise operation
- Can be above ground or pit type or combination thereof
- Double hot dip galvanized pallet wave boards for a very long life.

## CASE STUDY

### TOWER PARKING AT TRANSPORT BHAWAN, NEW DELHI

#### SALIENT FEATURES

- Client: National Highway Infrastructure Development Corporation
- Project Cost : 11.13 crore
- Parking Capacity: 112 Cars
- No. of Entry Lobby = 2 , No. Of Exit Lobby =2
- No of Floors: G+7
- Parking Space per floor: 16
- Covered Area: 322.32 M<sup>2</sup>
- Area per parking space: 10.92 M<sup>2</sup>
- Total Connected Load (KW) : 50KW
- Average Consumption per cycle (kWhr): 0.35 Units
- User time per Entry Operation: 40 Sec
- System cycle time per entry Operation: 88 sec
- Average Retrieval Time: 100 Sec
- Shortest Retrieval Time: 79 Sec
- Longest Retrieval Time: 130 Sec
- Mode of Operation: Smart RFID Technology with Touch panel
- No of Operators: 2
- Maintenance Schedule: Weekly, Monthly
- No of Maintenance Technicians: 2

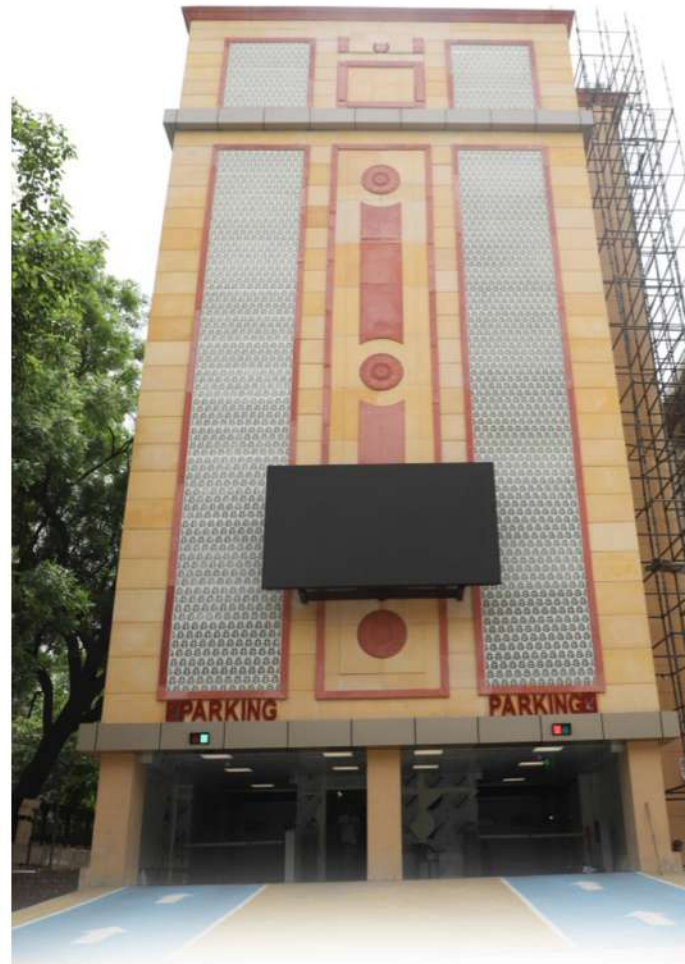

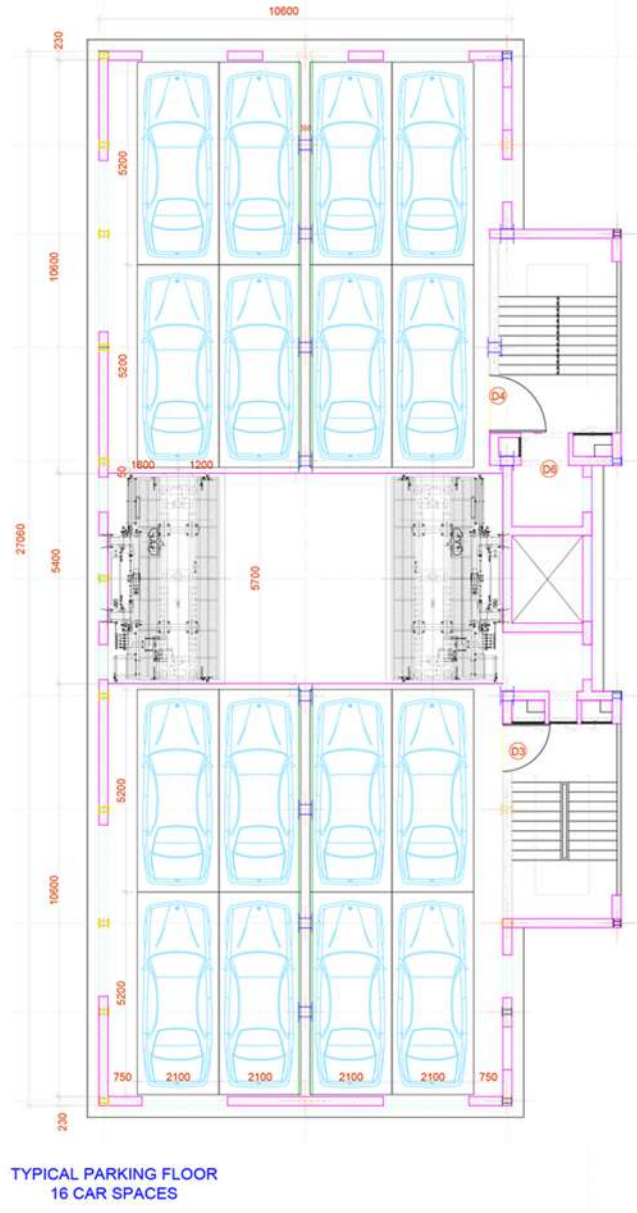
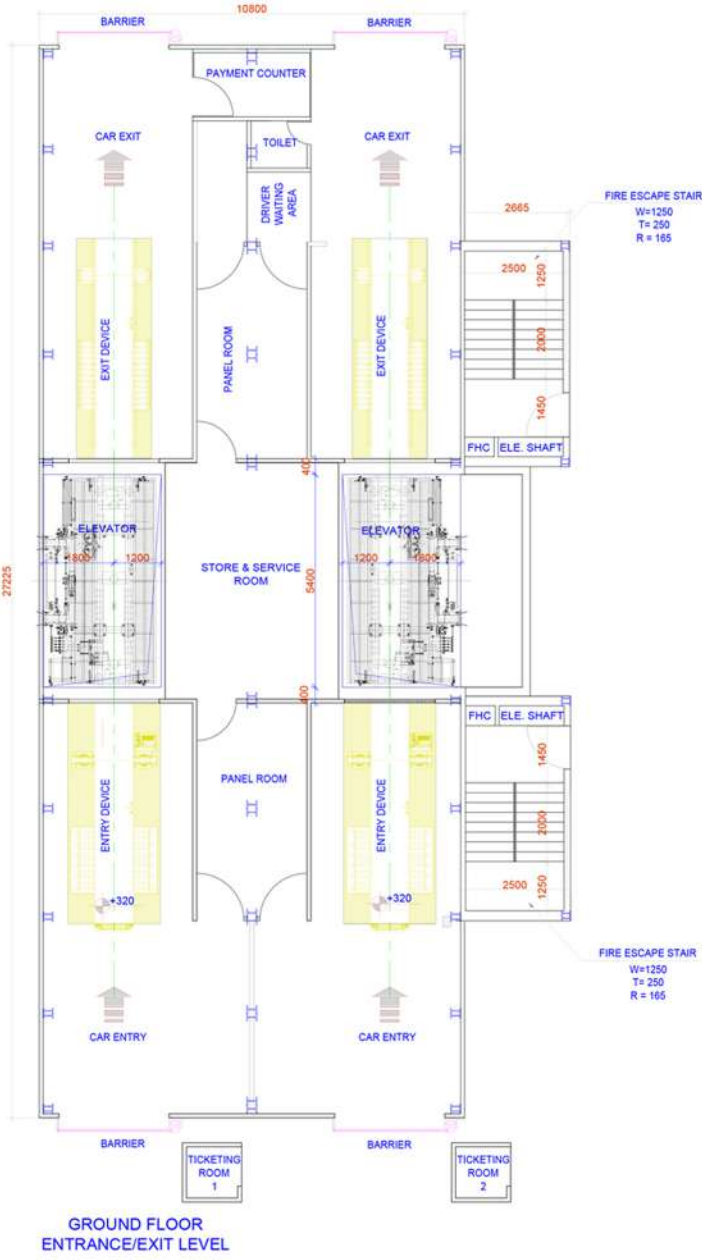

# PROJECTS



**PADMA SOCIETY**  
VILE PARLE WEST MUMBAI



**TOWER PARKING**



**SKY VUE SOCIETY**  
ANDHERI WEST MUMBAI



**MULTAN HEIGHTS**  
VILE PARLE WEST MUMBAI

**PUZZLE PARKING**



**HOTEL CHECK INN**  
BKC, MUMBAI



**PUZZLE PARKING**



**BLUE FORTUNA SOCIETY**  
MAROL, MUMBAI



**PARIVAHAN BHAVAN**  
NEW DELHI



**ANUPAM SOCIETY**  
MAROL, MUMBAI



**SPARK MALL**  
NEW DELHI



**OM SAI SOCIETY**  
GOREGAON

**TOWER PARKING**



**ROBOTIC SHUTTLE DOLLY:**  
PUBLIC PARKING

